

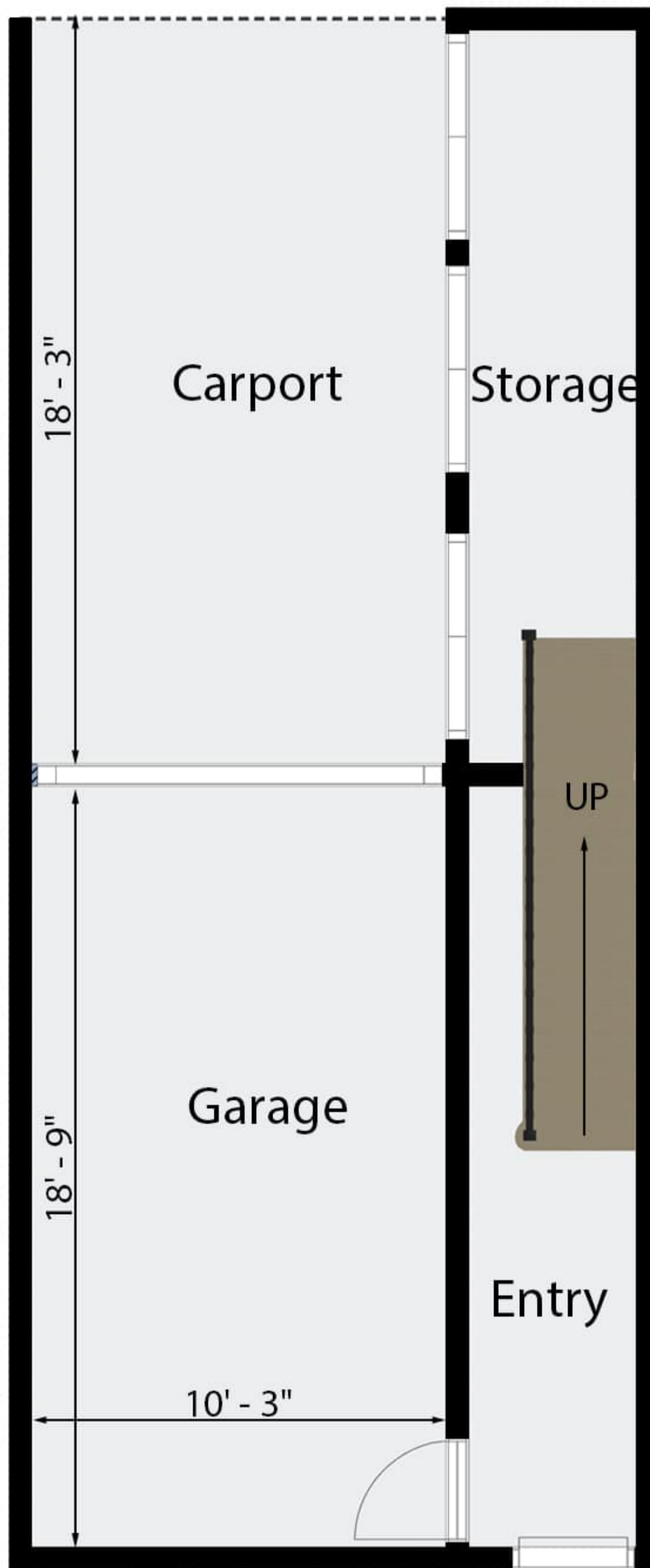

# ODESSA: URBAN LIFE WITH STYLE

## Two Bedroom + Garage + Carport



**FIRST FLOOR**  
285 SQ.FT.  
8' CEILING HEIGHT

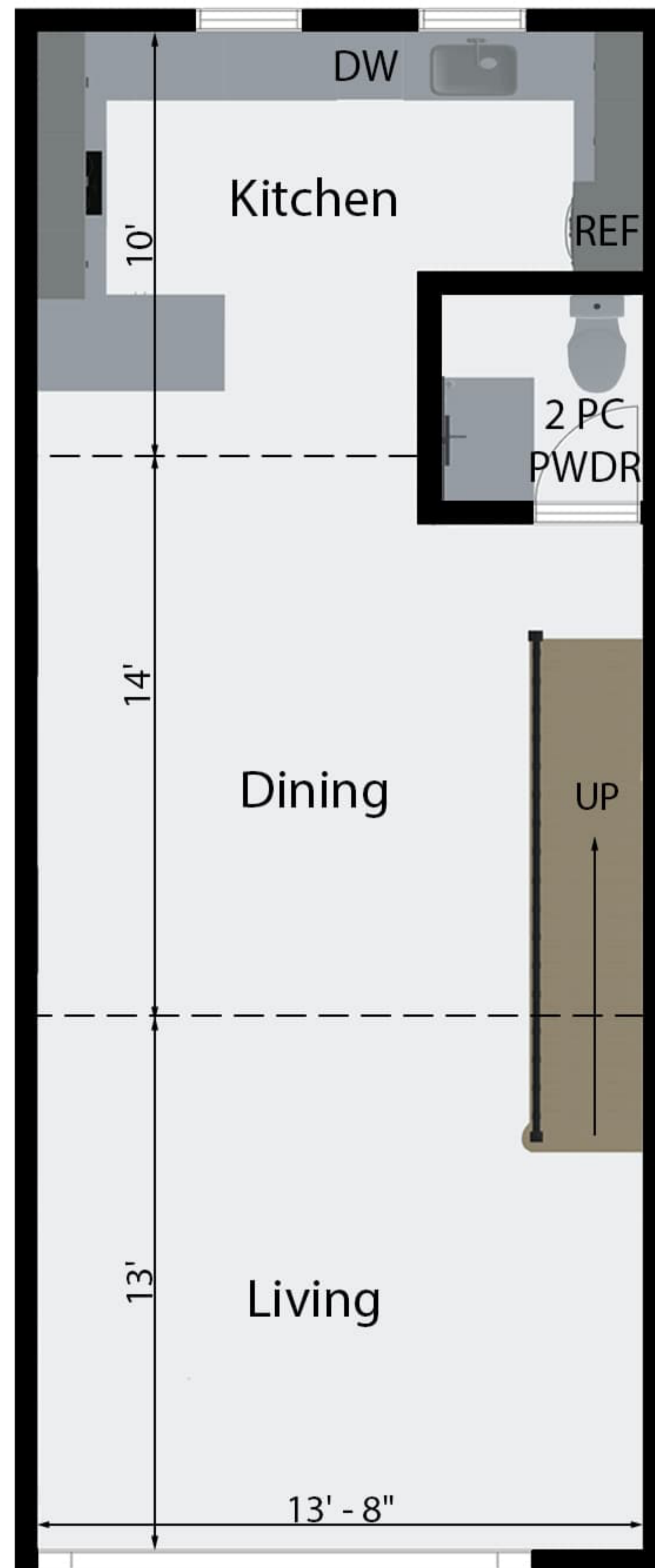

**SECOND FLOOR**  
512 SQ.FT.  
9' CEILING HEIGHT

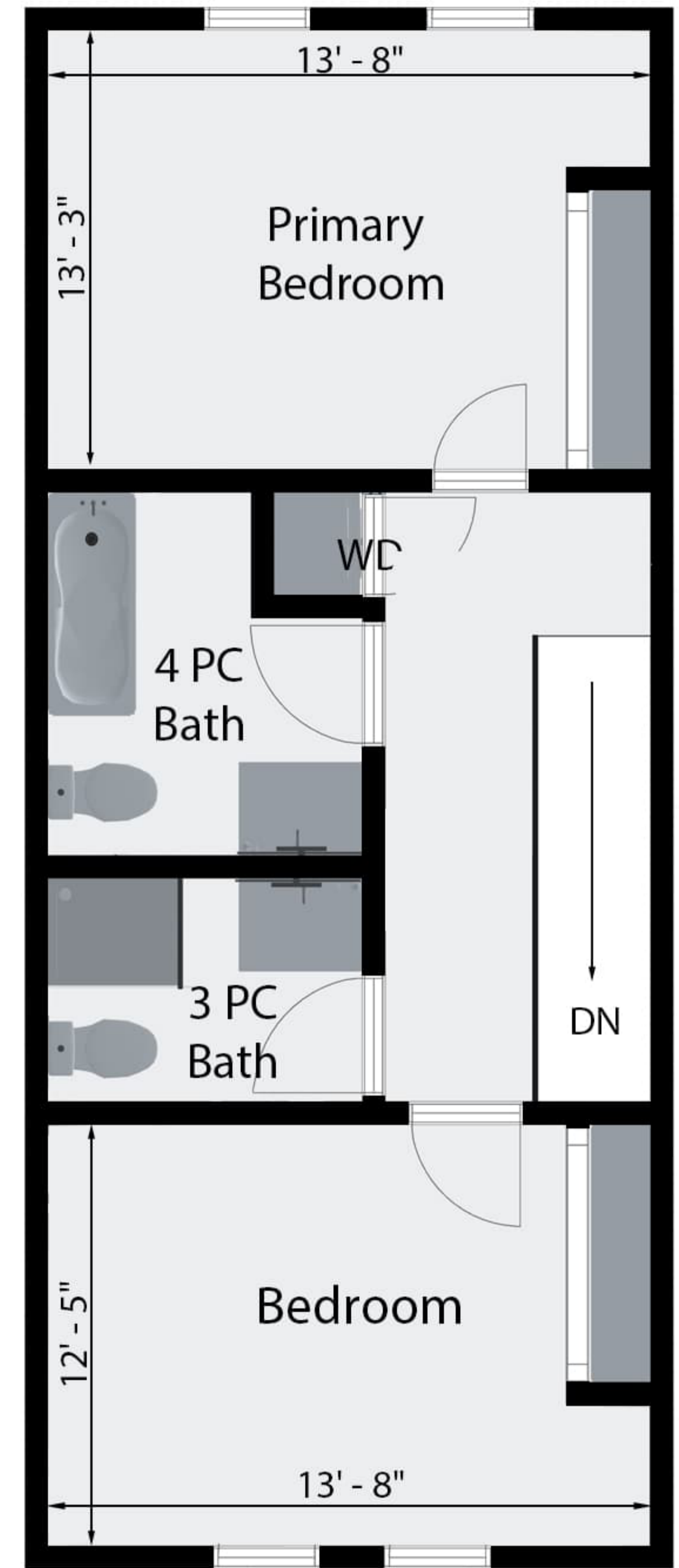

**THIRD FLOOR**  
512 SQ.FT.  
9' - 6" CEILING HEIGHT

**LIVE AT ODESSA**

2 BEDROOM  
GARAGE & CARPORT  
STORAGE  
PRIVATE FRONT PATIOS

TOTAL AREA: 1309 SQ.FT.  
GARAGE: 192 SQ.FT.  
LIVING SPACE: 1117 SQ.FT.

916 ORONO AVENUE, LANGFORD, BC

